

Division of Wildlife  
Ohio Department of Natural Resources  
**WELLINGTON WILDLIFE AREA**

Lorain County

Public Hunting & Fishing  
200 Acres



LEGEND

	Parking
	Grassland
	Brushland
	Woodland
	Pond F-Fish
	Fence Row
	Foot Trail
	Stream

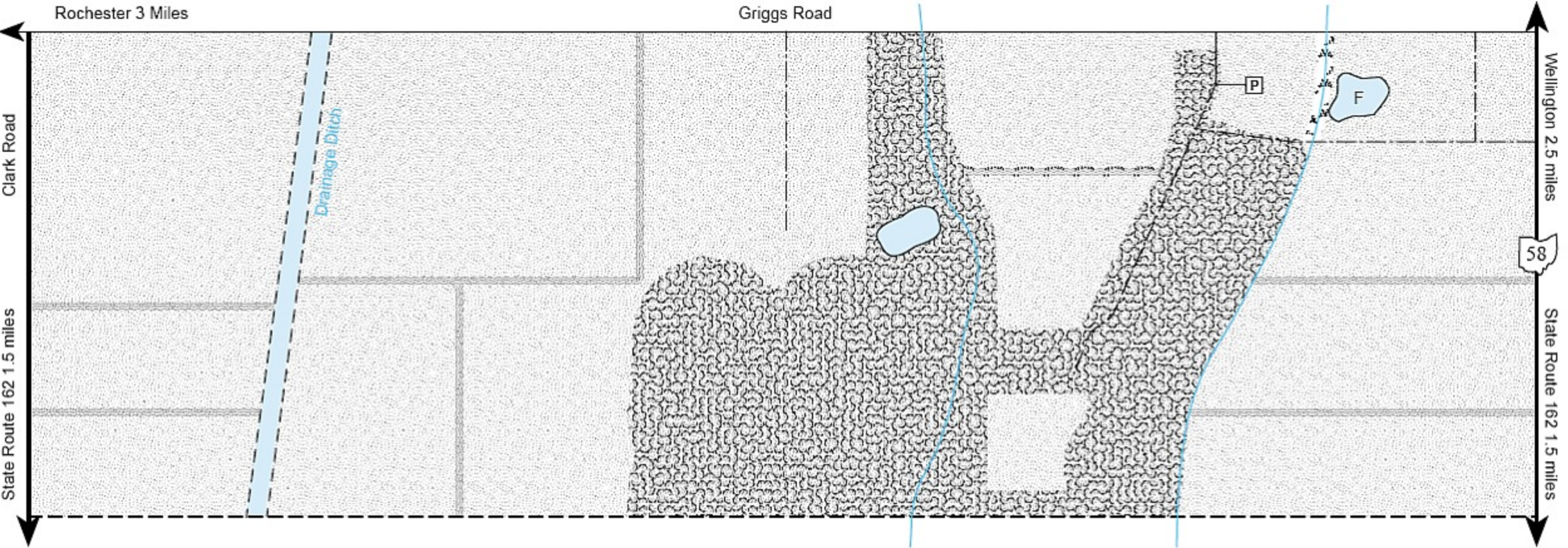
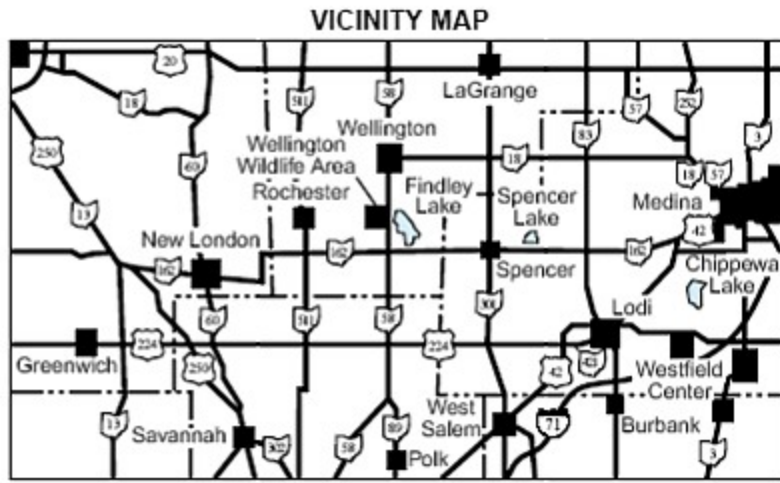

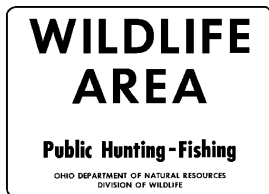

# WELLINGTON WILDLIFE AREA

Lorain County

## DISTANCE FROM MAJOR POPULATION CENTERS

40 miles from Akron  
20 miles from Ashland  
40 miles from Cleveland  
22 miles from Elyria  
32 miles from Mansfield  
27 miles from Norwalk

## LOCATION AND DESCRIPTION

This 200-acre wildlife area is situated in north central Ohio in Huntington Township, Lorain County. The area is 2.5 miles south of Wellington and is bounded on the east by State Route 58, on the north by Griggs Road, and on the west by Clark Road. Topography ranges from gently sloping to nearly level. The soils are well drained and of moderate to high fertility.

Approximately 72 percent of the area is openland; 18 percent is mature woodland of the beech-sugar maple climax forest, with tulip poplar, oaks, red maple, ash, and basswood. Brushland makes up the remaining 10 percent of the wildlife area.

## HISTORY AND PURPOSE

This was the original state game farm, purchased in 1917. The rearing of artificially propagated game birds was discontinued in 1960.

Management work has included protection and improvement of the woodlands, selection of areas that will be allowed to return to woodland through natural succession, and management of existing open fields based upon land capability. Crop rotations and cropping patterns have been developed to improve food and cover conditions for wildlife. Most management activities are directed toward upland game species.

Hunting is the major recreational use of the area. Wildlife observation, hiking, fishing, berry picking, nature study, and bird watching are other popular uses.

## FISH AND WILDLIFE

Two ponds on the area contain largemouth bass, bluegills, and bullheads. Cottontail rabbit, ring-necked pheasant, and fox squirrel are the principal game species. Groundhog, white-tailed deer, and all furbearers common to the region are found here. A great variety of both nesting and migrant birds use the area. Of particular interest to birding enthusiasts is the spring migration of songbirds.

## HUNTING, TRAPPING, AND FISHING

The Wellington Wildlife Area is popular for hunting rabbit, squirrel, groundhog, deer, and pheasant. Limited fishing is provided by two small ponds.

## PUBLIC USE FACILITIES

One parking lot is situated off Griggs Road.

## ADDITIONAL INFORMATION

More information on this wildlife area is available from the Wildlife District Three Office, 912 Portage Lakes Drive, Akron, Ohio 44319; telephone (216) 644-2293.

## TURN IN A POACHER

Ohio's TIP, "Turn In a Poacher," program is helping to curtail poaching throughout the state. TIP is designed to involve the public in reporting wildlife violations. Citizens who observe wildlife violations should call the TIP toll-free hotline, 1-800-POACHER.